

Poured Concrete (vertical)

Prepare Substrate

- x Remove form release agents used in the concrete construction process. Thoroughly clean all surfaces to be coated with ArcusStone® finish.
- x Remove paint by mechanical abrasion using: bead blasting, sand blasting, rotary steel wire brushing using an angle grinder or other methods to effectively open the coating and produce a surface profile similar to 80 grit sand paper. Completely removing the paint is usually not required.
- x Pressure washing, operated at approximately 1200 psi with a flare tip, may be used where possible.
- x Clean all surfaces of any efflorescence, mold, scale, soot, dirt or any other surface contaminants that may interfere with a good bond. Rinse with clean water.
Refer to ArcusStone Architectural Specifications Section 1.4D for ASTM Standards for preparing these substrates for ArcusStonecoat Finish installations.
- x Cut back or otherwise remove any embedded metal that is exposed in the surface to be coated.
- x Fill form tie, “rock pockets” and depressions with a cement grout patching compound or similar product.
- x Knock down any concrete spillover or similar protrusions to a min. height of 1/8” from face of substrate.
- x Surfaces must be free of mold, scale, dirt, debris, and excessive surface moisture.

Apply Basecoat: A Base coat is required to keep the form and/or mortar joints from “telegraphing” through to the ArcusStone finish coat. Select one of the following options for base coat:

Portland Cement Brown Coat

- x ArcusBond™ Using a roller, brush or sprayer, apply a generous and uniform coat of ArcusBond per manufacturer’s application instructions. Let dry before applying brown coat.
- x Apply brown coat, acrylic modified fiber reinforced, minimum thickness 1/8”. Scratch lightly horizontally.
- x Allow to cure for 48 hours.
- x ArcusBond™ is NOT necessary for installation of ArcusStone materials over NEW Portland cement stucco brown coats. It is recommended, however, to: even out the suction; prevent “flashing” of the ArcusStone material due to rapid moisture loss; avoid unwanted color variations; and to aid in bonding the ArcusStone materials to the substrate.

- OR -

Cementitious Acrylic Base Coat

- x Apply base coat and finish with a rough texture. Follow base coat manufacturer’s requirements for horizontal and wet locations.
- x ArcusBond™ Using a roller, brush or sprayer, apply a generous and uniform coat of ArcusBond per manufacturer’s application instructions. Broadcast (throw) 30 mesh (or equivalent) washed and graded sand onto the wet ArcusBond. Let dry before applying ArcusStone finish.

Waterproofing

- x Retaining walls must have either a waterproofing material applied to the back side of the wall prior to any back- fill of earth against the wall, or applied to the face of the wall. If applied to the face, the material must be non-asphalt based and compatible with the basecoat and ArcusStone finish.

REFER TO ARCUSSTONE
TECHNICAL LITERATURE FOR
COMPLETE DESCRIPTION OF
SUBSTRATE REQUIREMENTS AND
FINISH APPLICATION

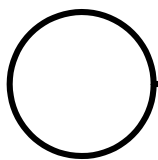
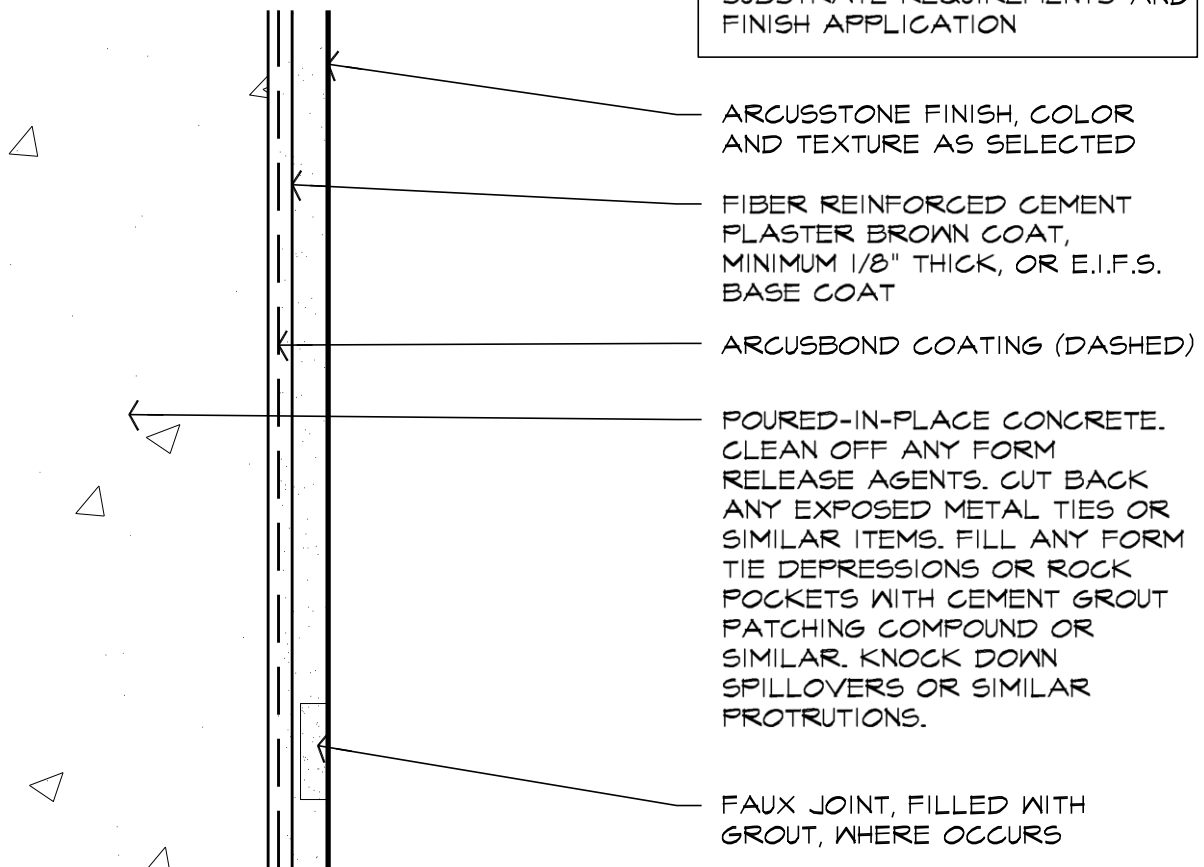

Poured Concrete (Vertical)

ArcusStone Substrate Preparation

Full Size

All substrates to be in compliance with local codes and regulations, substrate component manufacturer's requirements for installation, and ArcusStones' published guidelines.