

Exterior Sheathing Board

Approved For Direct Applied

- x **Cement-fiber boards** such as Hardibacker® 500
- x **Cementitious boards** such as PermaBase™ and DurRock™

Cement type boards must be installed according to the board manufacturer specifications, ArcusStone requirements and local building code requirements for exterior residential and commercial applications.

All approved cement type boards shall be completely covered with a minimum 1/8" thick cementitious basecoat with embedded mesh per board manufacturer's written specifications.

Approved With Additional Cladding Materials Installed

- x **Plywood, OSB, chipboard and wafer board**, installed to Code and manufacturer's specifications and clad with other exterior grade products or systems, such as: Fiberock AquaTough, PermaBase, Hardibacker™ or a Portland cement plaster stucco system that includes metal lath, 3/8" scratch coat and 3/8" brown coat.

Not Approved For Direct Application

- x **Fiberboard sheathing**, such as Celotex® and gypsum sheathing such as DensGlas Gold®, and the like.

Other Requirements and Considerations

- x Deflection limit of $L / 360$ with studs spaced no more than 16" o.c.
- x Stud minimum depth 5-1/2". Steel stud minimum 20 gage.
- x Minimum 1/2" board thickness required.
- x Must have a secondary weather barrier - either paper-backed metal lath attached thru to framing, or a weather resistive membrane such as Dryvit's Backstop NT - Smooth. (DS446) applied to the gyp sheathing after applying 4" grid tape to all joints and any exposed ends.
- x No one-coat applications when using paper-backed metal lath - Portland cement plaster shall be a minimum 3/4" thick (3/8" scratch and 3/8" brown) under the ArcusStonecoat or ArcusPlaster coatings.
- x Portland cement scratch and brown coats are to be acrylic modified and fiber reinforced.
- x If using a water resistive barrier such as Backstop NT – Smooth, all sheathing board surfaces must then be meshed and based with Genesis DM or equivalent, and standard mesh, prior to any direct-applied ArcusStonecoat or ArcusPlaster applications.
- x ArcusBond required to be used over cementitious acrylic basecoats such as Genesis DM.
- x All door, window, vent, and other openings are required to have a finish frame / molding installed.
- x Outside corners must be reinforced with metal corner reinforcement e.g. 3x3 Corner Rite.
- x All flashing, counter flashing and waterproofing must be installed.
- x All metal, including lath, flashing, corner guards, and fasteners, are to be corrosion resistant (galvanized, stainless, etc.).
- x All horizontal and vertical joints and inside corners must be reinforced as recommended by sheathing manufacturer. A smooth finish is not required but joint reinforcing should not project more than 1/8" ± from the face of the substrate.
- x Surfaces must be dry and clean of dust, debris, efflorescence, and staining.
- x Apply a **generous and uniform** coat of ArcusBond™ per manufacturer's application instructions. Let **dry** before applying any ArcusStone® finish.
- x ArcusBond™ is not necessary for installation of ArcusStone® finishes over **new** Portland cement stucco brown coats. See recommendations for Portland cement plaster – 3 coat stucco
- x **Contact an ArcusStone technical representative for questions concerning other sheathing substrates.**

Note! Please review the Climatic / Environment Precautions Section for further details and information

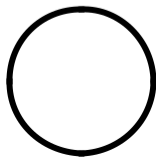
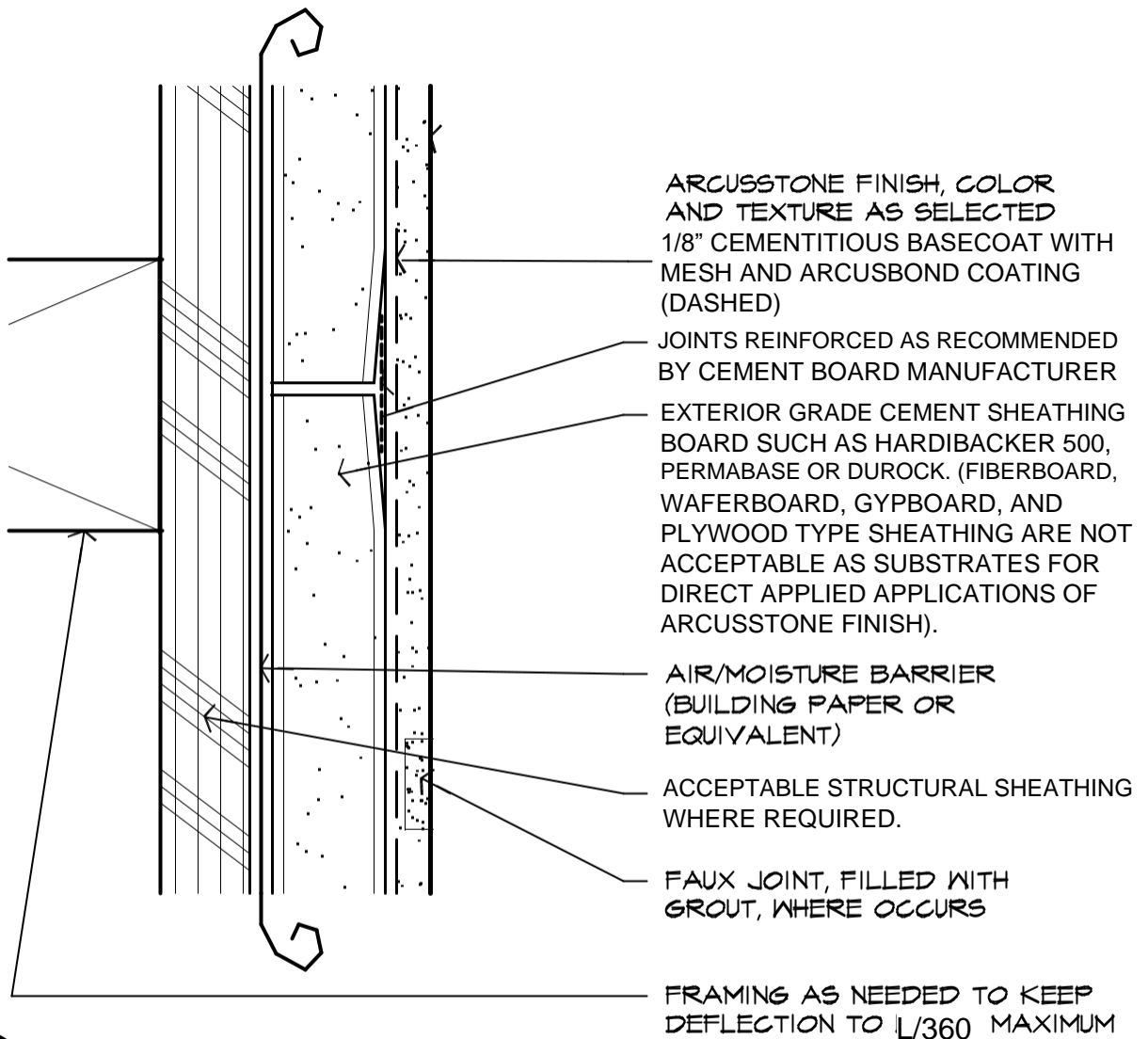

EXTERIOR SHEATHING BOARD

ArcusStone Substrate Preparation

Full Size

All substrates to be in compliance with local codes and regulations, substrate component manufacturer's requirements for installation, and ArcusStones' published guidelines.